

Prices & Packages  
Summer 2020

# TIME FOR ME.



  
GNOLLHOF  
\*\*\*\*\*





***A paradise of positive energy,  
for lovers of life***

*Tradition with a contemporary outlook.  
A warm welcome with mindful awareness:  
We have always known that all those  
who find their way here are looking for  
something special. And they find it! Decades  
of slow growth have shaped life here, and  
countless life stories have added to it:  
Like Margit and Peter, siblings and hosts,  
the fourth generation of the family to run  
the hotel; everybody who has found their  
own purpose in life here; and our staff,  
many of whom have been helping to write  
the Gnollhof history for a long, long time.*

*We and our team look forward to treating  
you to some TLC with our long-established  
comforts. And from spring 2020, the follo-  
wing new features will be adding an even  
more special touch to our range.*

- Mountain Spirit and Forest bedrooms*
- Infinity dining room*
- Wine corner and buffet area*
- New treatment and relaxation room in  
the wellness*

*Family Verginer*

## *Our Included Services*

### **All-inclusive cuisine**

- » Extensive breakfast buffet with regional products
- » Light buffet lunch
- » 4-course menu with salads from the buffet every evening
- » Breakfast 7.30 am - 10 am  
Lunch Snack 1 pm - 3 pm  
Dinner 6.30 pm - 8 pm

### **All-inclusive wellness**

- » Heated infinity pool with a view over the mountain peaks (8 am - 8 pm)
- » Indoor swimming pool with counter-current system and Jacuzzi (6.30 am - 8 pm)
- » Solar-heated open-air swimming pool (from mid-May to mid-September) with large sunbathing area
- » Hot tub with panoramic view to the Villnöss Dolomites (1 pm - 8 pm)
- » Panoramic and herbal sauna, Vitarium, Turkish bath „The Fire“, Brine bath, outdoor relaxation area with swing beds, mountain panorama relaxing area with waterbeds (10 am - 8 pm)
- » Fitness room with panoramic view (9 am - 8 pm)
- » Wellness area with teacorner and bath towels
- » Spa bag with bath towel and bathrobe
- » On request relaxing massage and beauty-treatments (at additional cost)

### **All-inclusive active**

- » Tennis court (sand, May to September), tennis racquet rental and tennis balls
- » Walker's Package: Rucksack, walking poles, walker's maps and umbrella provided for the duration of your stay

### **Online**

- » WIFI is available throughout the hotel for free









# Hiking Time, Nature Time, ME-TIME

*The warm season is here at last!  
The countryside is in full bloom,  
and all the marvels of nature and  
adventure of the mountains is  
yours to enjoy. Take a deep breath  
and live life at your own pace.  
And then lie back and enjoy our  
inclusive services (see page 3).*

## Time to blossom

23.04. to 21.05.2020

Tantalising scents, vibrant colours, living life to the full. All around you the countryside is awakening, drawing you outdoors, dancing in time to the melody of spring. Stop for a moment and behold the miracle.

Room type	3 nights	4 nights
	 Thurs  Sun	 Sun  Thurs
DR Lärche	297 €	376 €
DR Zirm	312 €	396 €
Suite Lärche	327 €	416 €
DR Mountain Spirit	375 €	480 €





Price per person - minimum of 2 guests per room



## Time-out in Autumn

18.10. to 01.11.2020

Vibrant leaves line the hiking paths, clear skies cast their shimmering light over the white Dolomite peaks. It's time for hikes, Törggelen expeditions and all the tastes of autumn: Live the magic of this season with all your senses.

Room type	3 nights	4 nights
	 Thurs  Sun	 Sun  Thurs
DR Lärche	297 €	376 €
DR Zirm	312 €	396 €
Suite Lärche	327 €	416 €
DR Mountain Spirit	375 €	480 €

Price per person - minimum of 2 guests per room

NEW

### Day Spa at the Gnollhof

#### Day Spa "light"

from 10 am to 7 pm

inclusive

Lunchtime snack from 1 pm to 3 pm

60 € per person

#### Day Spa "premium"

from 10 am to 7 pm

inclusive

Lunchtime snack from 1 pm to 3 pm

and dinner from 6.30 pm to 8 pm

95 € per person

 Check-in

 Check-out

Programmes may vary.

### *Double room Lärche*

2-4 people | approx. 30 m<sup>2</sup>



Spacious family room with larch furnishings with shower or bathtub, bidet, WC, hairdryer, telephone, satellite TV, safe, fridge, sofa bed or armchair and balcony.



### *Double room Zirm*

2-4 people | approx. 30 m<sup>2</sup>

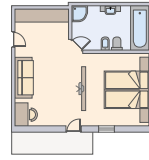

Spacious family room with Swiss stone pine furnishings with shower and bathtub, bidet, WC, hairdryer, telephone, satellite TV, safe, fridge, sofa bed and balcony.



### *Double room Forest*

2-4 people | approx. 30 m<sup>2</sup>

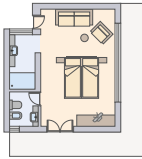

Spacious single room with oak furnishings with shower, separate WC and bidet, hairdryer, telephone, satellite TV, safe, fridge, sofa bed and balcony.



### *Double room Alpin*

2-4 people | approx. 30 m<sup>2</sup>

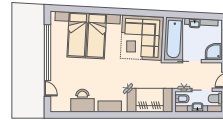

Spacious single room with oak and reclaimed wood furnishings with shower and bathtub, separate WC and bidet, hairdryer, telephone, satellite TV, safe, fridge, sofa bed and balcony with view over the Funes Valley.





## Double room Mountain Spirit

2-4 people | approx. 38 m<sup>2</sup>

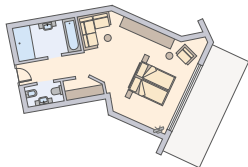

Spacious single room with oak furnishings with shower and bathtub, separate WC and bidet, hair-dryer, telephone, satellite TV, safe, fridge, sofa bed and balcony with view over the Funes Valley.



## Lärche Suite

2-4 people | approx. 40 m<sup>2</sup>

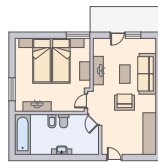

Spacious two- room suite with larch furnishings with shower or bathtub, WC, bidet, hairdryer, telephone, satellite TV, safe, fridge, sofa bed and balcony.



## Fichte Suite

2-4 people | approx. 40 m<sup>2</sup>

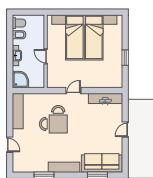

Spacious two- room suite with spruce furnishings with shower, WC, bidet, hairdryer, telephone, satellite TV, safe, fridge, sofa bed and balcony.



## Zirm Suite

2-5 people | approx. 50 m<sup>2</sup>

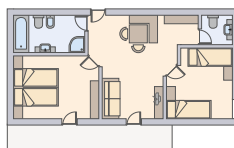

Spacious suite with bedroom, living room and children's room with Swiss stone pine furnishings with separate WC, bathroom with shower and bathtub, WC, bidet, hairdryer, telephone, satellite TV, safe, fridge, sofa and balcony.



There may be deviations in room plans and photos.

<i>Prices 2020</i>		DR Lärche	DR Zirm	DR Forest	DR Alpin	DR Mountain Spirit	Suite Lärche	Suite Fichte	Suite Zirm
23.04. – 28.05.20	1 day	104 €	109 €	111 €	120 €	130 €	114 €	120 €	126 €
	4 days Sun - Thu	396 €	416 €	424 €	460 €	500 €	436 €	460 €	484 €
	7 days Sun - Sun	658 €	693 €	707 €	770 €	840 €	728 €	770 €	812 €
	10 days Thu - Sun	940 €	990 €	1.010 €	1.100 €	1.200 €	1.040 €	1.100 €	1.160 €
	11 days Sun - Thu	1.034 €	1.089 €	1.111 €	1.210 €	1.320 €	1.144 €	1.210 €	1.276 €
28.05. – 05.07.20	1 day	110 €	116 €	118 €	124 €	134 €	121 €	124 €	132 €
	4 days Sun - Thu	420 €	444 €	452 €	476 €	516 €	464 €	476 €	508 €
	7 days Sun - Sun	700 €	742 €	756 €	798 €	868 €	777 €	798 €	854 €
	10 days Thu - Sun	1.000 €	1.060 €	1.080 €	1.140 €	1.240 €	1.110 €	1.140 €	1.220 €
	11 days Sun - Thu	1.100 €	1.166 €	1.188 €	1.254 €	1.364 €	1.221 €	1.254 €	1.342 €
05.07. – 13.09.20	1 day	116 €	121 €	123 €	131 €	141 €	126 €	131 €	138 €
	4 days Sun - Thu	444 €	464 €	472 €	504 €	544 €	484 €	504 €	532 €
	7 days Sun - Sun	742 €	777 €	791 €	847 €	917 €	812 €	847 €	896 €
	10 days Thu - Sun	1.060 €	1.110 €	1.130 €	1.210 €	1.310 €	1.160 €	1.210 €	1.280 €
	11 days Sun - Thu	1.166 €	1.221 €	1.243 €	1.331 €	1.441 €	1.276 €	1.331 €	1.408 €
13.09. – 04.10.20	1 day	110 €	116 €	118 €	124 €	134 €	121 €	124 €	132 €
	4 days Sun - Thu	420 €	444 €	452 €	476 €	516 €	464 €	476 €	508 €
	7 days Sun - Sun	700 €	742 €	756 €	798 €	868 €	777 €	798 €	854 €
	10 days Thu - Sun	1.000 €	1.060 €	1.080 €	1.140 €	1.240 €	1.110 €	1.140 €	1.220 €
	11 days Sun - Thu	1.100 €	1.166 €	1.188 €	1.254 €	1.364 €	1.221 €	1.254 €	1.342 €
04.10. – 08.11.20	1 day	104 €	109 €	111 €	120 €	130 €	114 €	120 €	126 €
	4 days Sun - Thu	396 €	416 €	424 €	460 €	500 €	436 €	460 €	484 €
	7 days Sun - Sun	658 €	693 €	707 €	770 €	840 €	728 €	770 €	812 €
	10 days Thu - Sun	940 €	990 €	1.010 €	1.100 €	1.200 €	1.040 €	1.100 €	1.160 €
	11 days Sun - Thu	1.034 €	1.089 €	1.111 €	1.210 €	1.320 €	1.144 €	1.210 €	1.276 €
Single room supplement		+20 €	+20 €	+20 €	+45 €	+55 €	+30 €	+45 €	+45 €

DR= Double Room

**Children's discount: Up to third birthday, free of charge; up to 6th birthday - 70% discount, up to 10th birthday - 50% discount, up to 14th birthday - 30% discount, 3rd person in room - 20% discount**

Prices are per person and night including VAT and the Gnollhof luxury board. There will be a surcharge of € 2.50 per person and day on the respective room price to cover statutory local taxes. (aged 14 and over)



**Have you thought about your insurance yet?** A travel insurance policy will cover you in the event of statutory cancellation costs. If you haven't done so, then get in touch to ask about our travel cancellation insurance.

## *Worth knowing*

- » The Gnollhof luxury board offer begins on the day of arrival at 2.00 pm and ends on the day of departure at 10.00 am. You are welcome to enjoy the lunch buffet on the day of your departure for a price of € 15.00.
- » Please note that we can not accept table reservations for the dining room in advance.
- » The price per person for additional breakfast is € 15.00, dinner € 35.00 and lunch buffet € 15.00.
- » No reduction is given if midday meals or breakfast are not taken.
- » Please note that we can only accept reservations for less than 3 nights' accommodation at short notice.
- » Room reservation is binding on receipt of written confirmation of reservation. (We will strive to meet your request if you specify a certain room number with your desired room type, but we cannot give any firm, binding undertaking in this regard).
- » Rooms are available from 2.00 pm on your day of arrival. We would ask you to notify reception if you will be arriving later than 6.00 pm.
- » Please vacate your room by 10.00 am on the day of departure.
- » Dogs on request. For your four-legged friends, we charge 5€ per day. You are asked to bring a blanket and basket for your dog. Please note that dogs are not permitted in the dining area or in the Vital World.
- » Please bring your own slippers to help us cut down on waste and do our bit to help the environment. If necessary, disposable slippers are available at reception.
- » Laundry with washing machine and dryer available (€ 5.00/washing)
- » Payment: your bill can be paid up to 9.00 pm on the day before departure or from 8.30 am on the day of departure, in cash or by Visa, Mastercard or EC card.  
Our bank details: Raiffeisenkasse Untereisacktal,  
SWIFT-BIG RZSBIT21313,  
IBAN IT 95 Q 08113 58310 000303000419
- » Cancellation fees: No charges will be incurred for cancellations made more than eight weeks before arrival. After this period, we charge 70% of the booked hotel stay. Early departures are charged at 100% of the booked stay. We ask for your understanding in this matter, and recommend that you avoid cancellation charges by taking out our inexpensive travel insurance policy. It will only cost 5% of your booked stay, and will ensure that you are covered in the event of legally binding cancellation fees.
- » Note: the new price list supersedes and replaces all previous versions. All price adjustments, printing errors and mistakes as well as changes to the offer excepted.

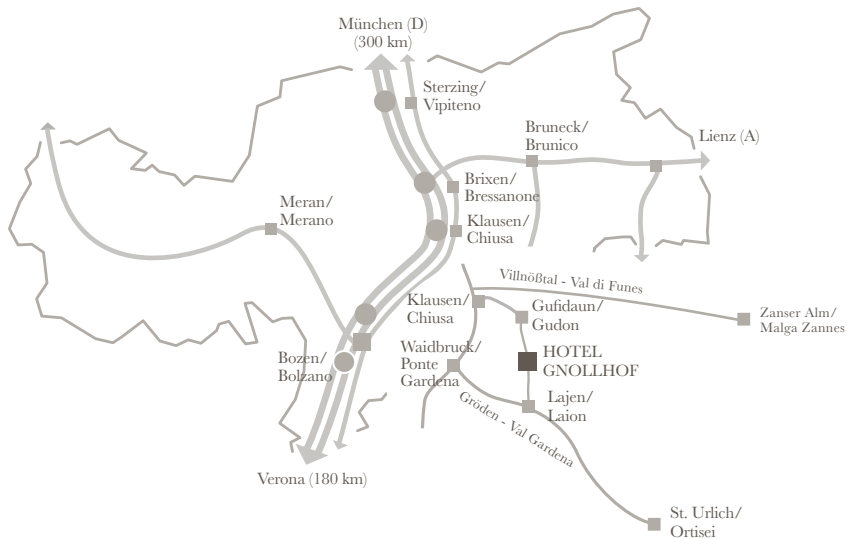

Hotel Gnollhof | Family Verginer  
 Gufidaun/Gudon 81 | I-39043 Klausen/Chiusa  
 T +39 0472 847323 | [info@gnollhof.it](mailto:info@gnollhof.it)  
[www.gnollhof.it](http://www.gnollhof.it)

